

Plemons Options



ASSEMBLY 2002406 BOX CLAMP OPERATING CAM/ CABLE ARM ASSEMBLY

ITEM	PART NO.	DESCRIPTION	QTY.
1	0079206	BRACKET, LOWER BRACKET	1
2	0039600	SPACER	1
3	0026202	ARM, COMPRESSION PIVOT	1
4	0015400	CAM, CLAMP OPERATING	REF
~	0015401	CAM, CLAMP OPERATING (P.O)	REF
*	0053000	PLATE, CABLE MOUNTING	2
*	0050600R/L	BAR, LOWER MOUNT	1/1
100	0200100	BUSHING	REF
101	0203100	BUSHING	1
102	0500700	1 3/8" CAM ROLLER	1
103	1201900	SPRING	1
104	8007000	1/4-20 HEX HD CAP SCR X 1	1
105	8035900	3/8 FLAT WASHER	2
106	0011503	CABLE, COMPRESSION (2-84)	1
107	0011502	CABLE, COMPRESSION (2-48)	1
108	0501001	3/8 ROD END	4
109	8036900	7/16 SPLIT LOCK WASHER	2
110	8024600	7/16-14 STD HEX NUT	2
111	8010800	3/8-16 HEX HD CAP SCR X 3	1
112	8036800	3/8 SPLIT LOCK WASHER	2
113	1501600	PMS WASHER	3
114	8024500	3/8-16 STD HEX NUT	1
115	8014600	1/2-13 HEX HD CAP SCR X 2 1/2	1
116	8037000	1/2 SPLIT LOCK WASHER	1
117	1501601	PMS WASHER	1
118	8010200	3/8-16 HEX HD CAP SCR X 1 1/2	1
119	8025700	3/8-16 NYLON LOCK NUT	1
120	8024300	1/4-20 HEX NUT	1
121	8011800	7/16-14 HEX HD CAP SCR X 1 1/4	2

* NOT SHOWN
~ VARIABLE PART

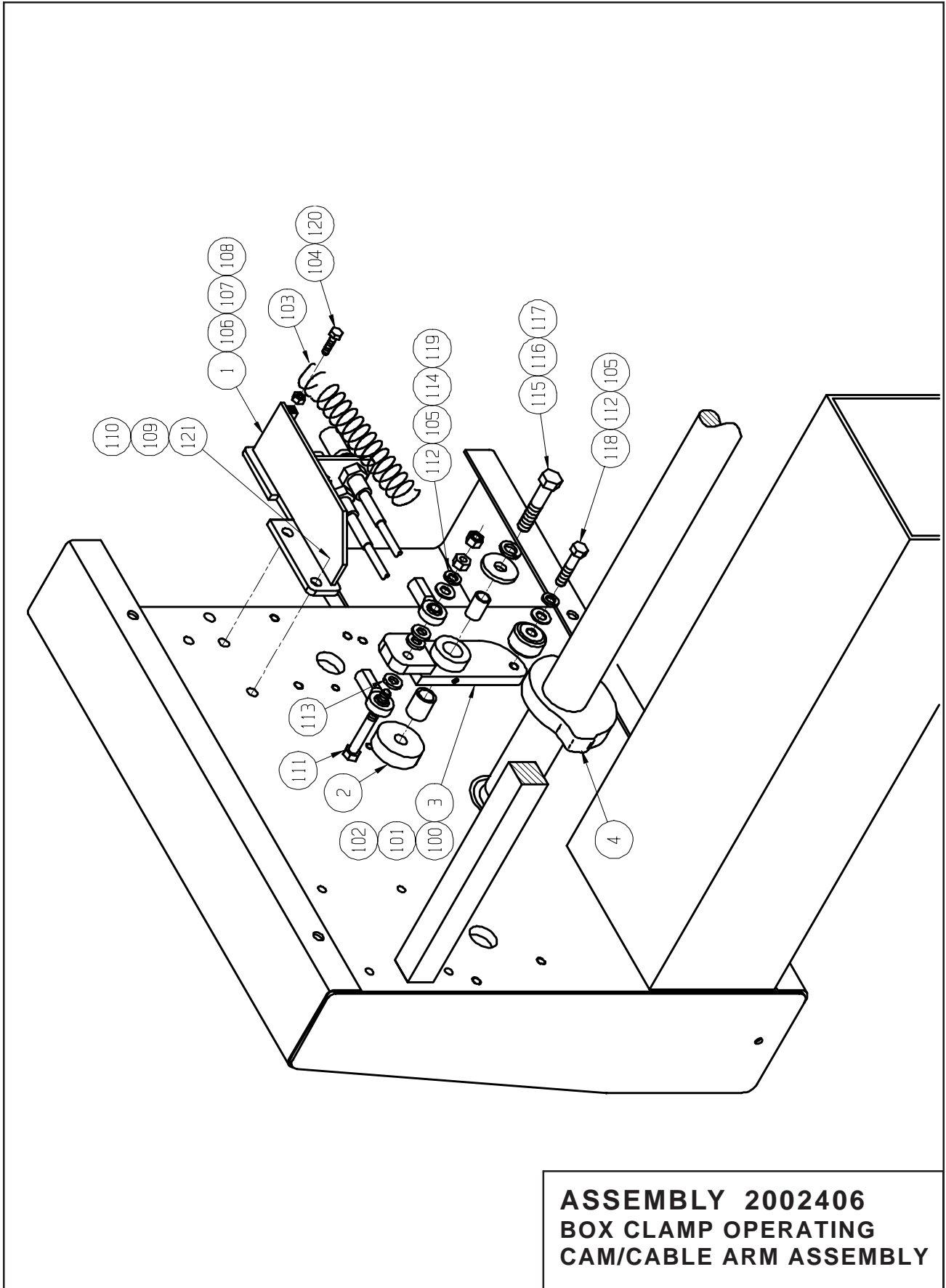

ASSEMBLY 2002406
BOX CLAMP OPERATING
CAM/CABLE ARM ASSEMBLY